

# Pulse PRO

## FEATURES

### KEYPAD

- 10 alphanumeric keys
- Keypad test
- Automatic DST
- Red Led
- Buzzer
- Battery compartment
- Dallas key reader
- Fixed/rotating keypad
- Battery level test
- Buzzer silencing function
- Function keys
- Power
  - 9V alkaline battery
  - battery box
  - power supply

*Not all the features are available in the standard configuration. Please remember to request the desired functions.*



### LOCKS

#### SwingBolt



#### DeadBolt



#### LatchBolt



#### Motor LatchBolt Lock



#### MotorLock



#### MotorLock Push&Pull



- 2 Master
- 3 Manager
- 49 users
- 10 override users
- Expiration of codes
- Time delay 1-99 minutes
- Open window 1-19 minutes
- Silent alarm and Remote disable opening
  - or Remote time delay override
- Door open alarm
- Bolt status output
- Penalty
- Dallas key management
- Dual mode
- Audit trail with time and date 8.000 events
- Pre-programmed configurations (more than 80)
- Fully configurable by keypad
- Hotel mode
- Master reset
- Hardware reset
- ERC – Emergency Rescue Code



# Pulse PRO

## Pulse PRO Keypad

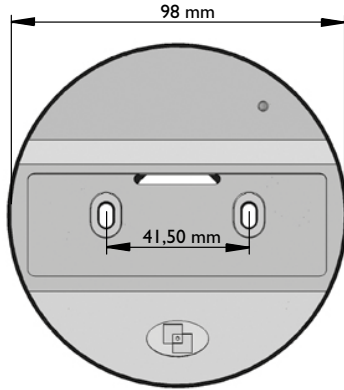

## SwingBolt

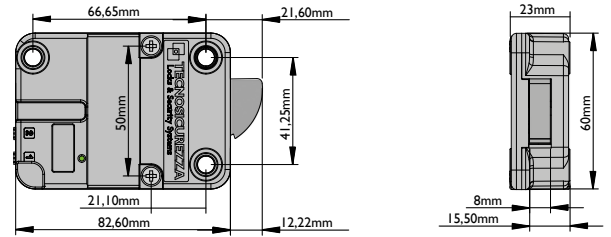

## DeadBolt

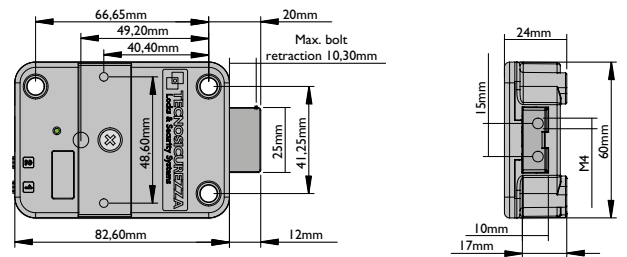

## LatchBolt

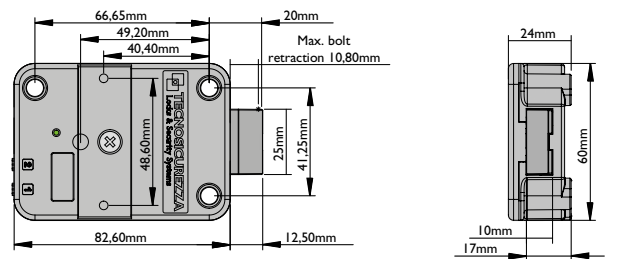

## MotorLock/MotorLock Push&Pull

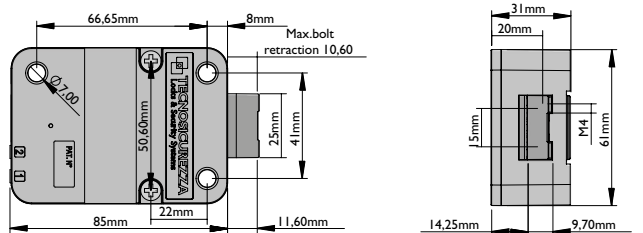

## Motor LatchBolt Lock

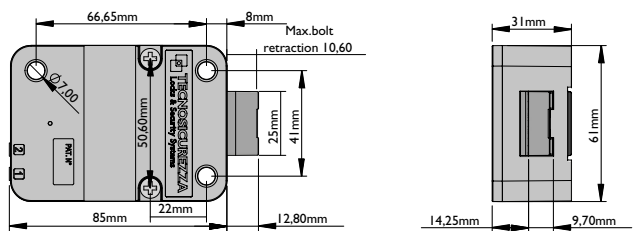

v. 2.2-23

### GLOBAL HEADQUARTERS

Tecnosicurezza SpA  
Via C. Battisti, 276  
37057 S.Giovanni Lup.(VR)  
ITALY  
info@tecnosicurezza.it  
www.tecnosicurezza.it

### USA HEADQUARTERS

Tecnosicurezza Inc  
133, Trade Street-Suite 4  
Lexington, KY 40511  
USA  
info@usatecno.com  
www.usatecno.com

### SPAIN HEADQUARTERS

Tecnosicurezza SA  
C/Menor, 4 - Nave 10, Pol Ind. "La Mina"  
28770 Colmenar Viejo  
SPAIN  
info@tecnosicurezza.es  
www.tecnosicurezza.es